

CIEL
DUBAI MARINA



THE FIRST GROUP
HOSPITALITY

Located in Dubai Marina, Ciel offers incredible 360-degree views in all directions, to Downtown Dubai and the Burj Khalifa to the East, Dubai Marina to the South West and out towards Palm Jumeirah and the Arabian Gulf to the North.



DUBAI MARINA

The world's largest man-made marina, is one of the most exciting and frequently visited destinations in the city.

This vibrant mini-metropolis boasted an impressive 82% occupancy rate in 2023 and is conveniently located just five minutes from Jumeirah Beach Residence.

82%

Occupancy rate
in 2023

5 Minutes

To Jumeirah Beach
Residence & beach

#1

Location for
water sports

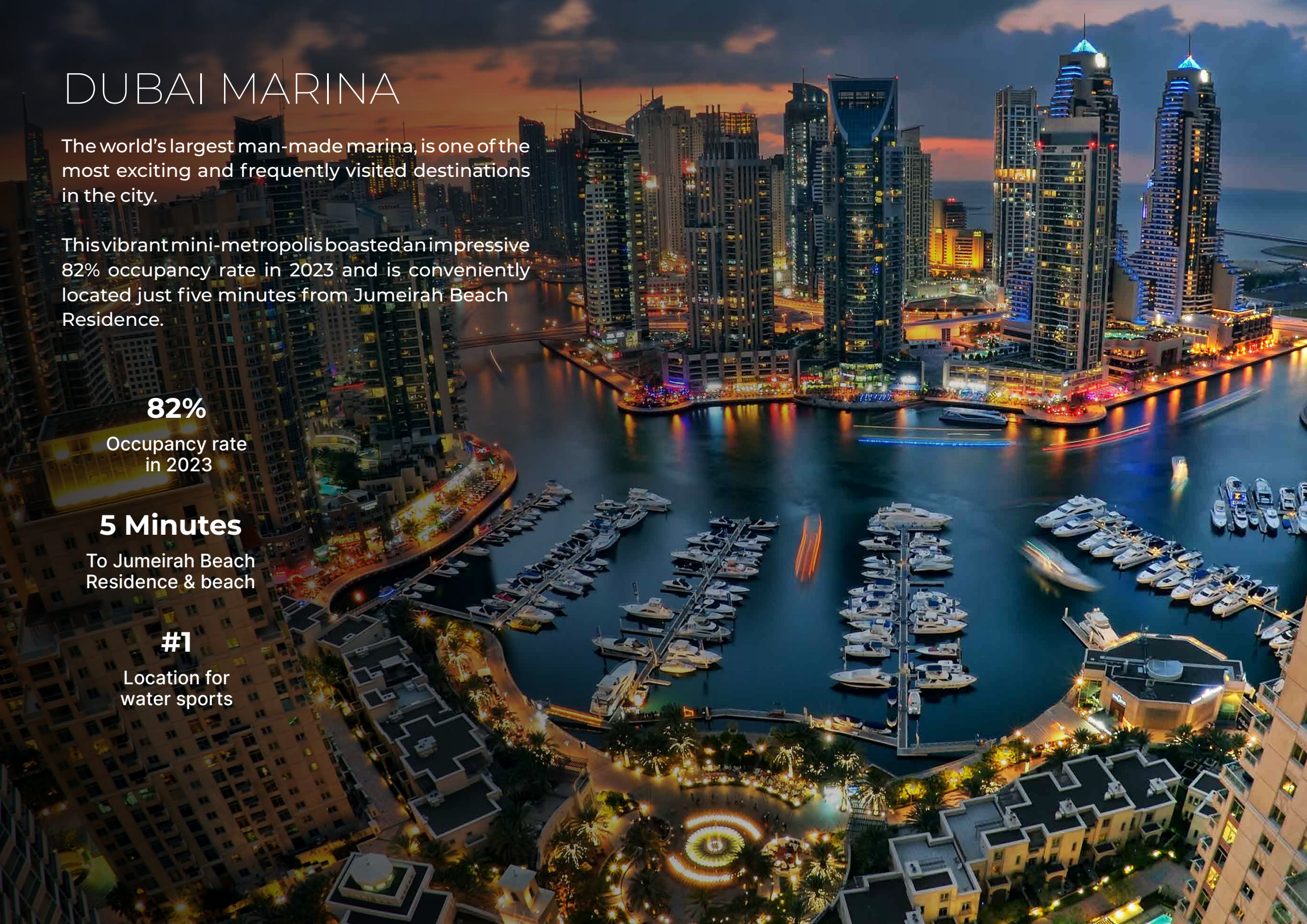

DUBAI HARBOUR

Maritime lifestyle like no other

1,100

Berths including super
yacht capacity

2

Cruise ship terminals

1.2M

Projected annual
passengers

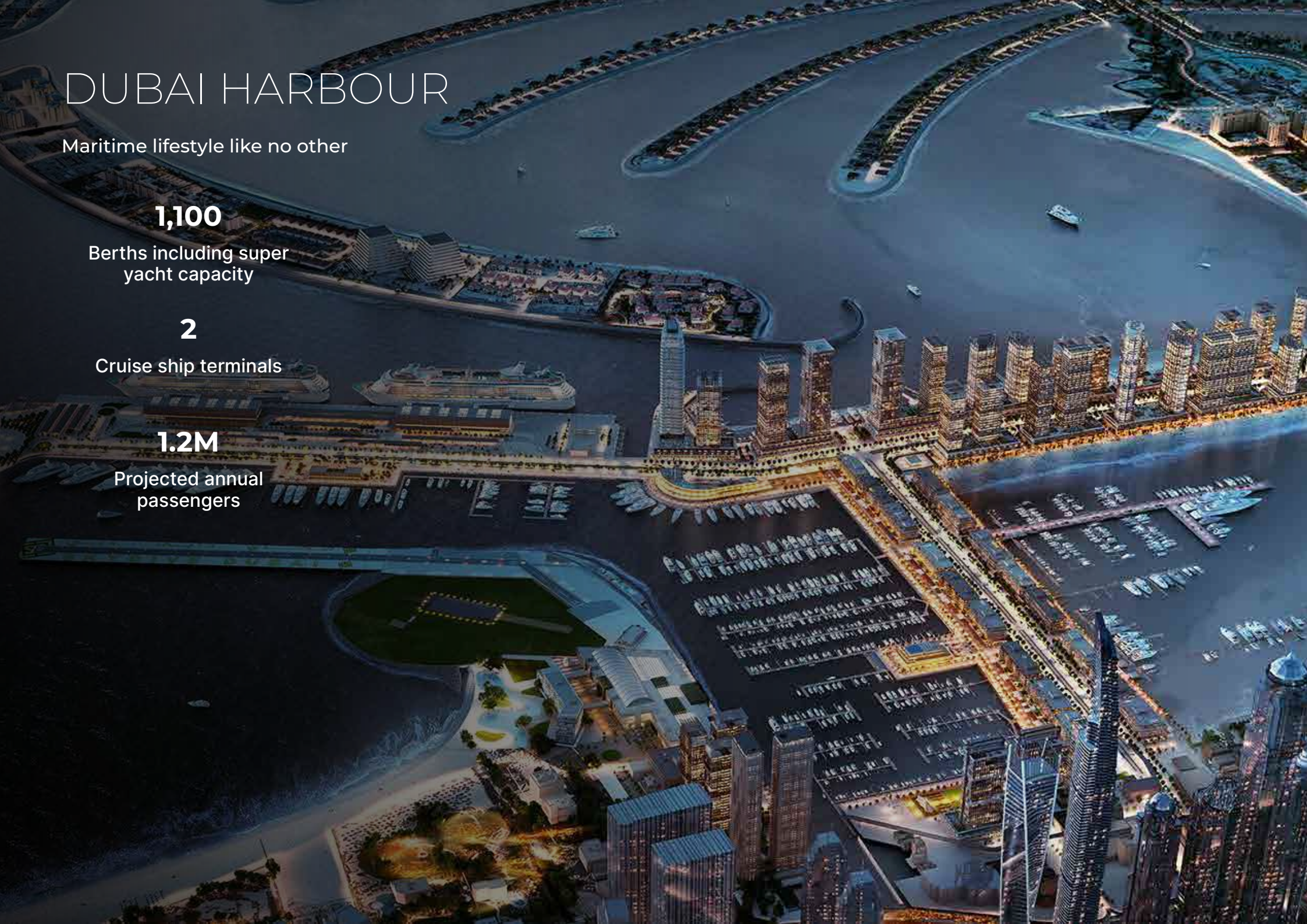

DESIGN OVERVIEW

Designed by award-winning London-based architect NORR.

Its remarkable design, featuring an elegant “eye of the needle” shape and an infinity pool deck on the 76th floor, showcases a revolutionary approach to mega-tower architecture.

Ciel’s striking silhouette is a testament to its iconic status and vision to create the extraordinary. The translucent façade offers breathtaking views of the Arabian Peninsula from every angle. Ciel’s architecture and design are driven by a quest for clarity and elegance.

The result is a building that is both dramatic and understated. Singular in form, the detailing of the tower and podium is intentionally abstract and minimalist.

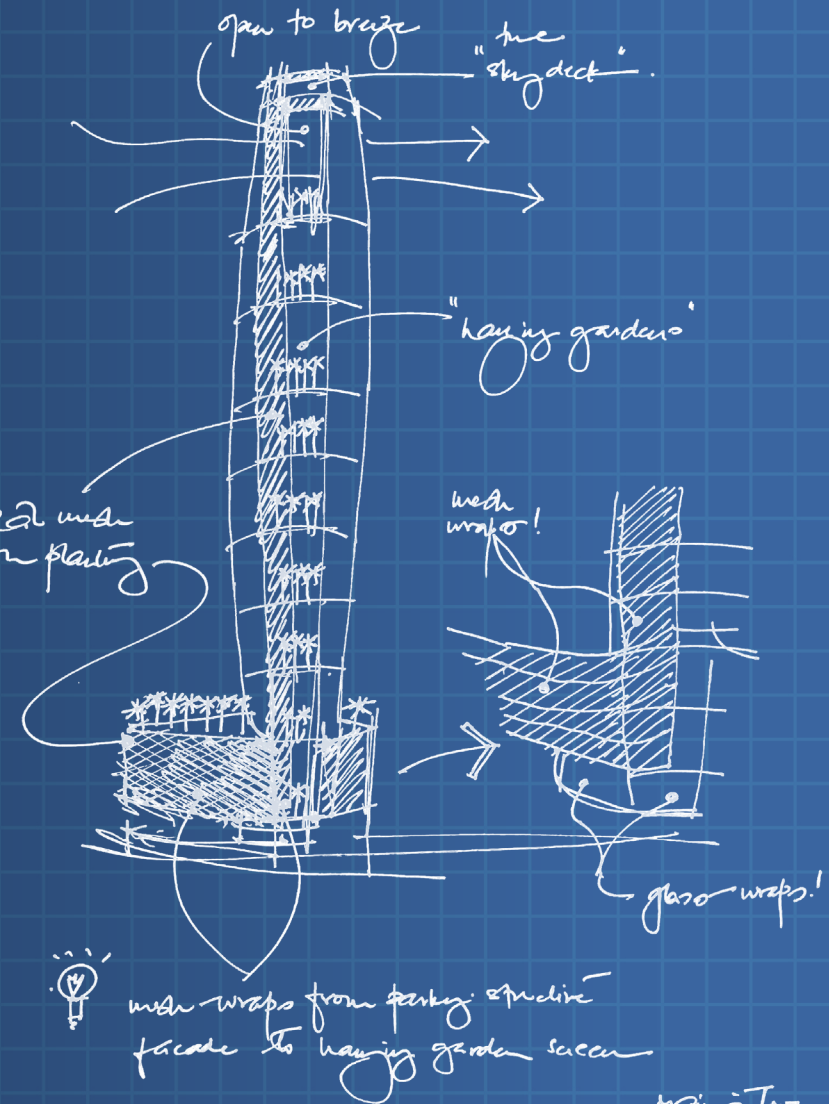
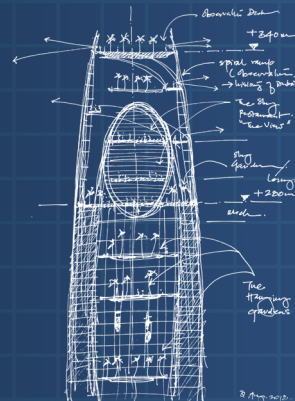
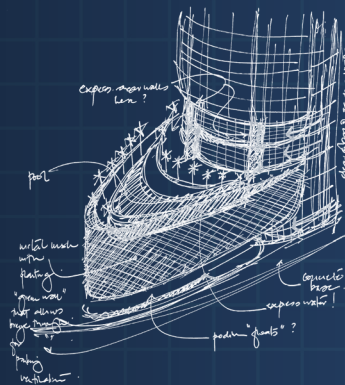
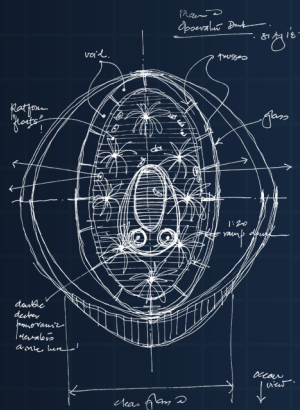

main tower
09.08.2018.

NORR

DESIGN OVERVIEW

Ciel is dedicated to sustainable architecture, embodying a 'breathable skyscraper' design that incorporates natural ventilation into its state-of-the-art structure.

This forward-thinking philosophy has garnered significant recognition, with Ciel winning the 2019-2020 International Property Award for Best International Hotel Architecture, Best Hotel Architecture Arabia, and Best High-rise Architecture Arabia.



DESIGN OVERVIEW

The shaping of the tower was heavily influenced by wind tunnel testing and computational fluid dynamic modeling to minimize wind loads on the structure and related loading on the subterranean foundations.

The design of this 81-story tower features vertically stacked atrium gardens, incorporating trees and green walls throughout.

During the cooler months, guests will be able to enjoy the incoming sea breeze as the building's glass facade features computerized louvers that allow ambient air into the garden spaces.

This approach creates a healthy environment, offering shared communal spaces that reflect our social goals.



CIEL, DUBAI MARINA

CIEL
DUBAI MARINA

Reaching a remarkable height of 365 meters, Ciel in Dubai Marina is a stunning development that will set a new global benchmark as the world's tallest hotel upon completion. The architectural masterpiece is the latest landmark addition to the marina district's world-famous skyline, and the first group's largest and most luxurious project to date.

82

Floors

1,000

Hotel Rooms & Suites

5

Signature Restaurants

Multi-Award Winner

Panoramic
Sky Terrace

Infinity Pool

INTERNATIONAL
PROPERTY
AWARDS

★★★★★

WINNER 2019 - 2020



ARABIAN
PROPERTY
AWARDS

★★★★★

WINNER 2019 - 2020



BEAUTIFULLY DESIGNED ROOMS

With modern amenities and spectacular Gulf views, every room and suite at Ciel offers an unparalleled experience.

Featuring stunning floor-to-ceiling panoramic glass windows, our rooms invite guests to immerse themselves in the outstanding Dubai vista, creating a sense of vastness and wonder.

Each room is equipped with every possible amenity to fulfill guests' expectations of this incredible property, including self-closing curtains.



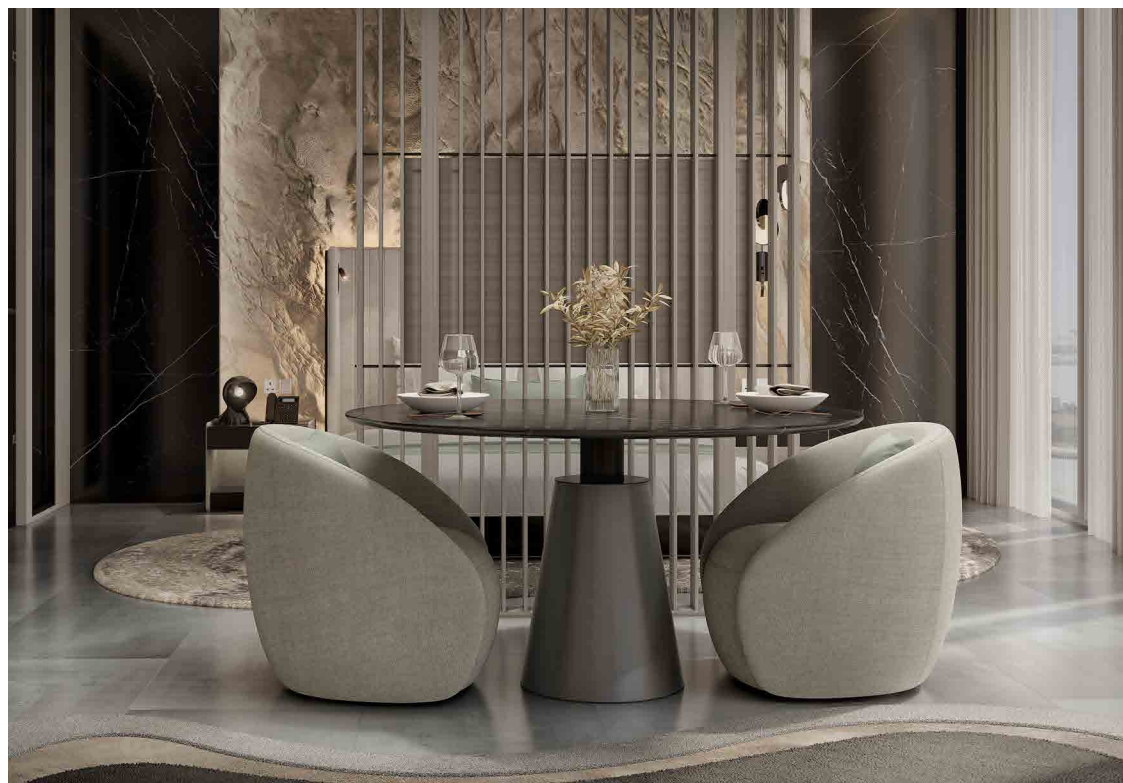

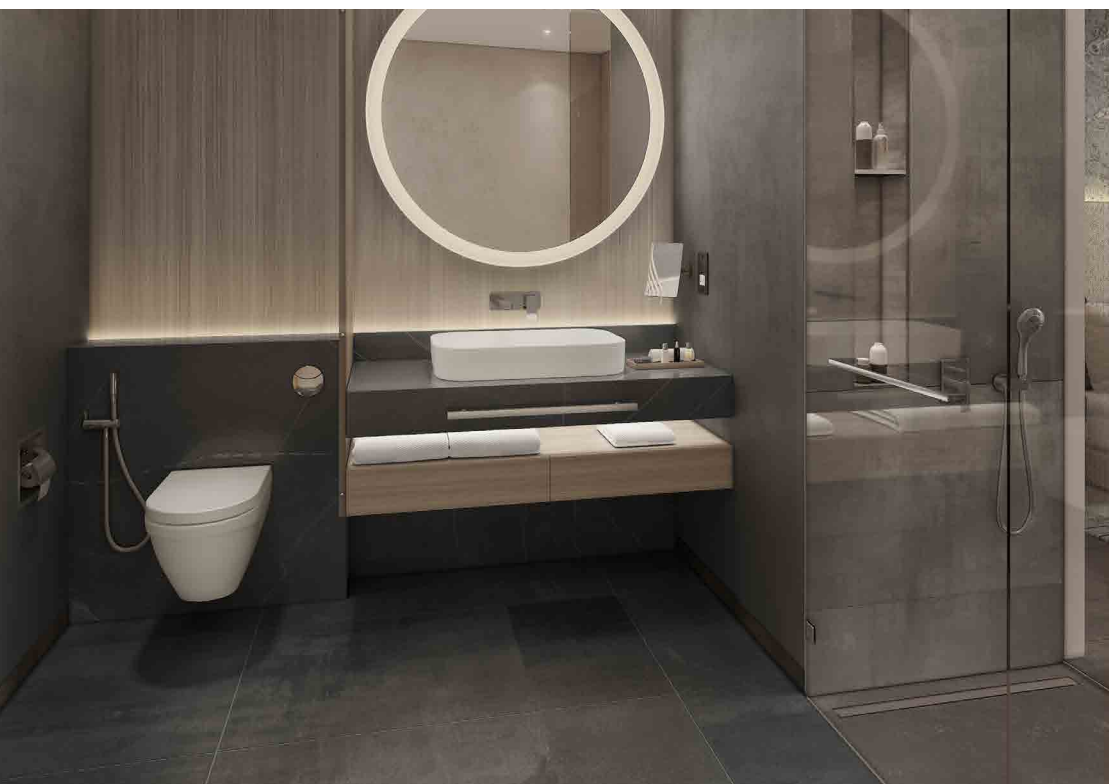

GUEST FACILITIES & SERVICES

- Luxury Spa
- State-Of-The-Art Gymnasium
- Nest Guest Lounge
- Observation Deck On (81st Floor)
- World's Highest Infinity Pool (76th Floor)
- Podium Pool And Children's Pool
- Children's Play Area
- Culinary Masterpieces



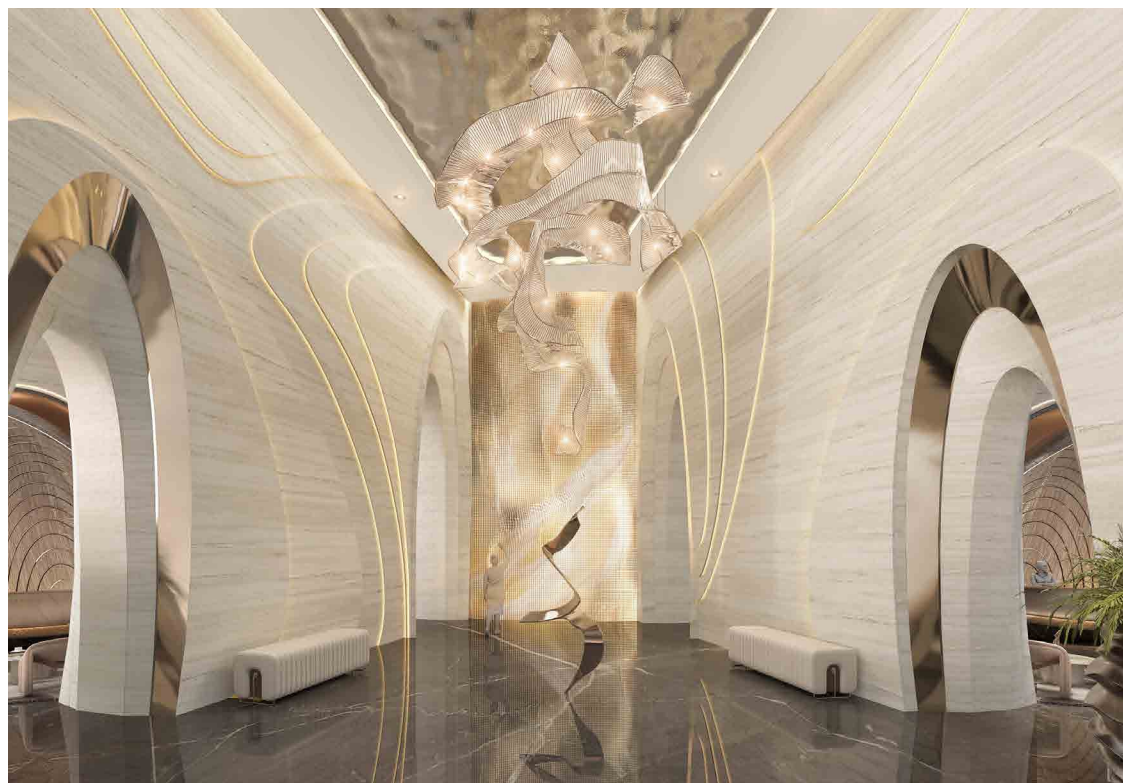
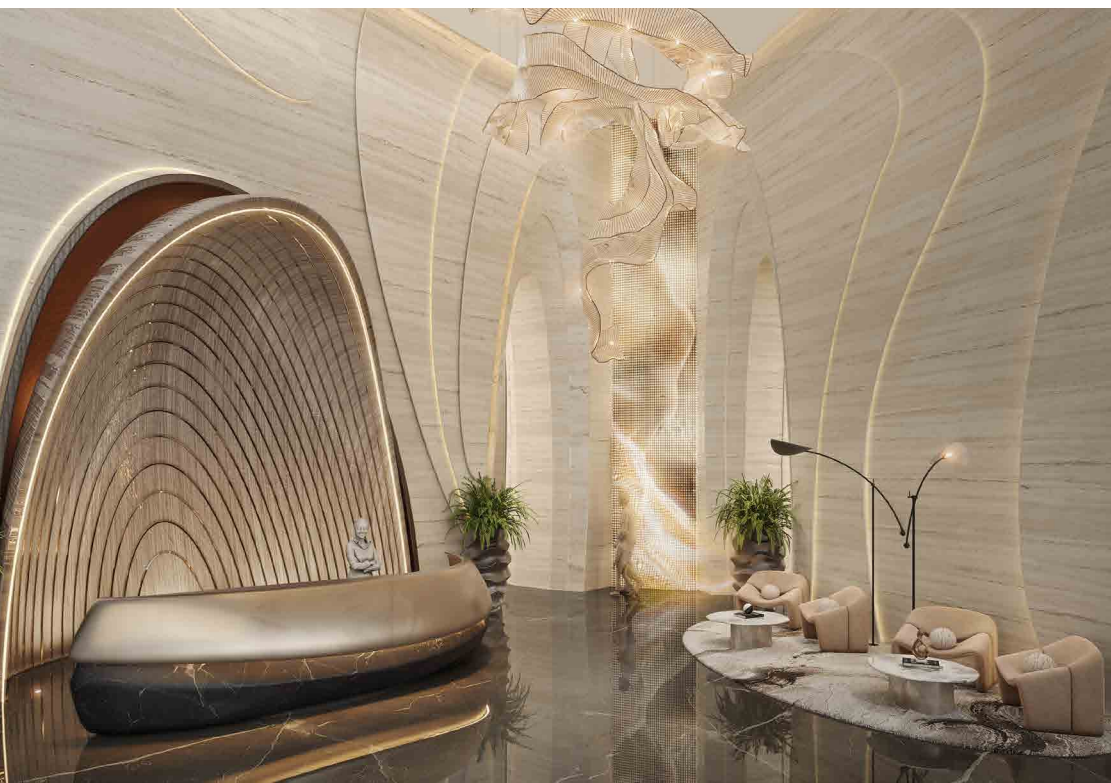



Infinity Pool



Gym



spa



Swimming Pool



Guest Lounge



Meeting Area



Observation Deck

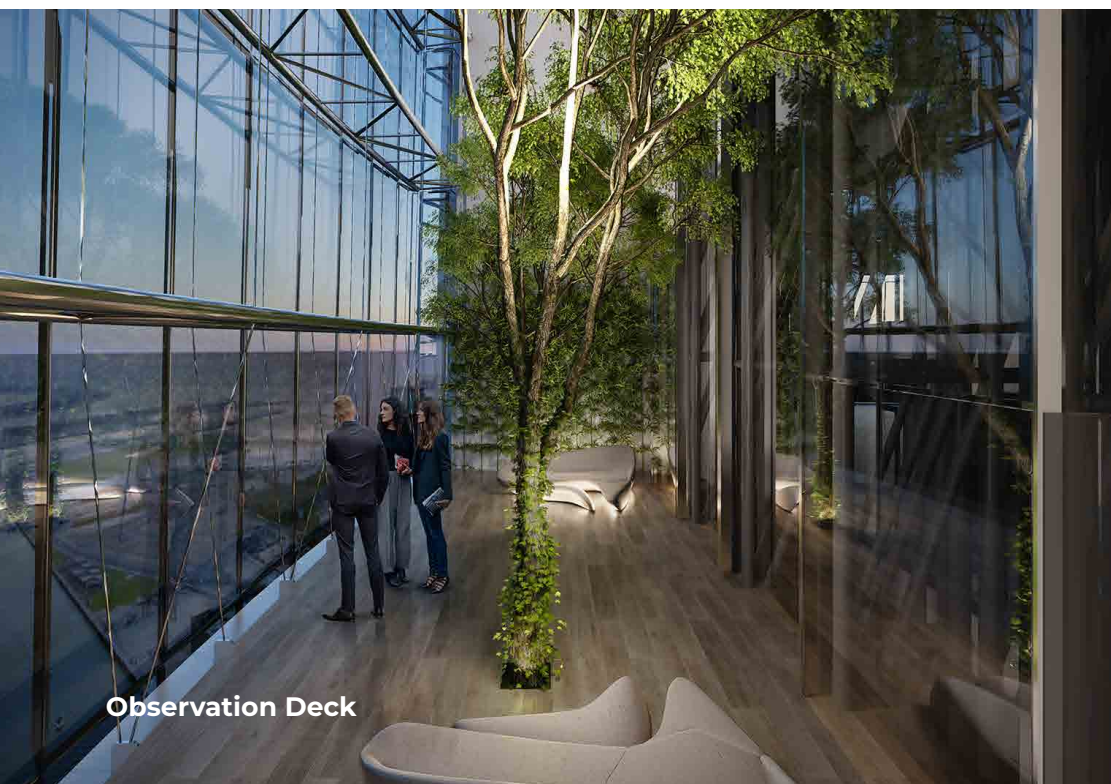

Observation Deck



FOOD AND BEVERAGE

The iconic Ciel Tower, the world's tallest hotel, will set new & exciting frontiers related with immersive, mind-blowing food & beverage experiences.

With over 10 different F&B offerings to be provided, the aim is to make sure every experience is as unique, extraordinary & memorable creating natural reoccurrences for every guest.

RISEN CAFÉ AND ARTISANAL BAKERY

LOBBY & 16TH FLOOR

Welcome to Risen, our homegrown café and artisanal bakery in Dubai. With a strong focus on sustainability and locally sourced ingredients, Risen Café & Artisanal Bakery offers a breakfast, brunch and all-day menu featuring a wide selection of classic and specialty confectioneries, delicious café-style food and pastries in Dubai.



Tripadvisor

#1 of 116 Bakeries in Dubai



POOL DECK

11TH FLOOR

Experience a seamless blend of traditional and modern Mediterranean vibes with our all-day menu, featuring vibrant, popular poolside dishes and a focus on international cuisine. Enjoy a wide selection of freshly blended fruit and vegetable juices, perfectly complementing our diverse offerings.



ALL-DAY DINING

13TH & 14TH FLOORS

West 13

Inspired by cuisines from the Western world. Consisting of the most exciting cuisines that will be showcased effectively flowing buffet restaurants that split the themes and crowds into different areas & experiences.

East 14

Inspired by cuisines from the Eastern world showcased effectively flowing buffet restaurants that split the themes and crowds into different areas & experiences.

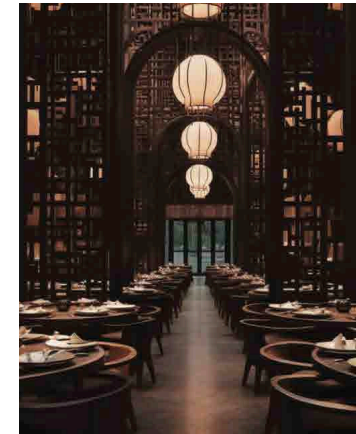

MEETING SPACE

15TH FLOOR

When it comes to meeting and event spaces, the food and beverage concept is a crucial aspect of the overall experience. Here are some key considerations and trends in food and beverage concepts for meetings and events in hotels.

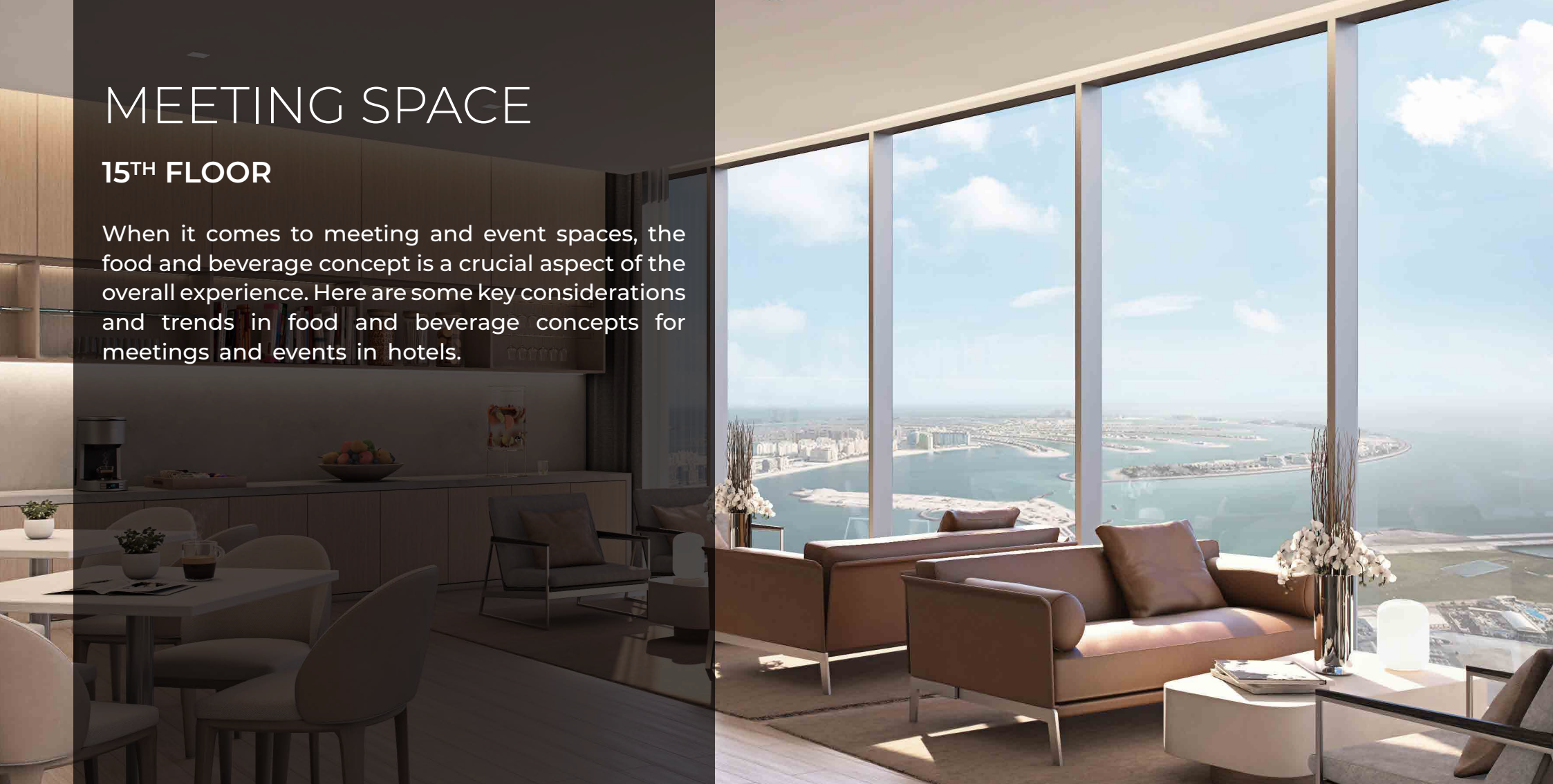

THE NEST SOCIAL

16TH FLOOR

The VIP concept for in-house guests will feature a European-inspired breakfast selection, a daily à la carte menu with snack options, and evening drinks with Mediterranean canapés. The VIP Lounge will be open throughout the day and evening, offering a full beverage selection, including a unique international wine collection, cocktails, mocktails, a variety of beers and spirits, and bottle service. Additionally, screens in the Nest will cater to live events and news, enhancing the overall experience.



SIGNATURE RESTAURANT

74TH, 76TH & 81ST FLOORS

Signature restaurant exemplifies the evolution of Chinese cuisine by blending inventive, concept-driven design with contemporary cooking techniques and presentation. It delivers 'Aspirational Luxury' to a broader audience compared to other premium venues, capturing a larger share of the 18 to 35 age demographic.



CIEL
DUBAI MARINA

LOCATION

THE FIRST GROUP HOSPITALITY



www.thefirstgroup.com